

LAYOUT

CONCEPTS

NCE PowerCab With Alpha Box & Alpha Power & NCE AutoSwitch

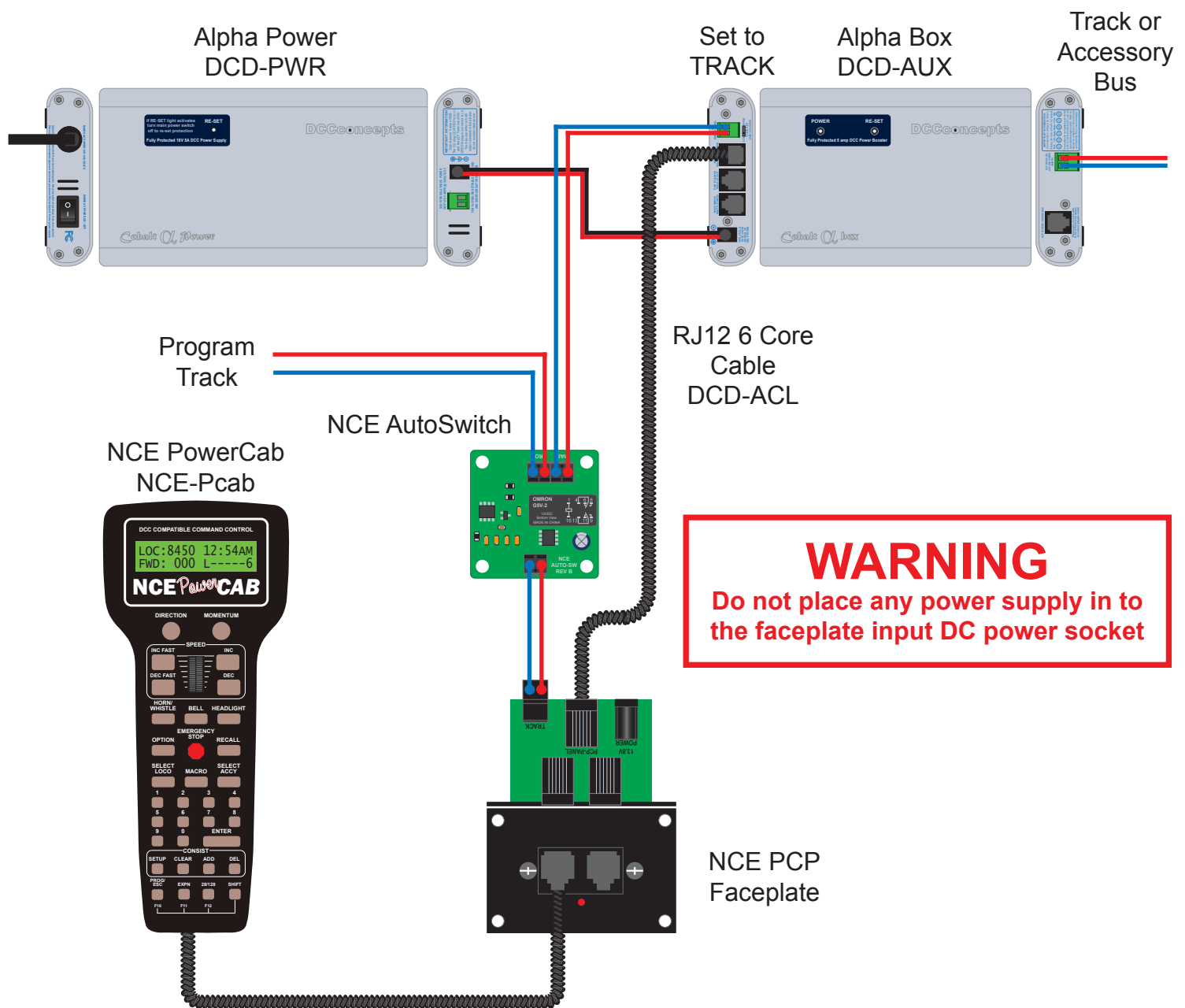

The NCE PowerCab control cable **MUST** be connected to the **LEFT** socket on the NCE PCP faceplate with the LED faceplate at the bottom.

DCD-ACL curly cord or NCE Flat Cord - **NOT THE NCE curly cord.**